

CITTÀ

AB Pendant

Installation & Assembly Instructions

This product should only be installed by a registered electrician. Please read product manual before installation.

Step 1

Disassemble the mounting bracket from the ceiling rose, fix the bracket onto the ceiling by 2pcs of screws,

(The input power cord should pass through the center hole of the bracket).

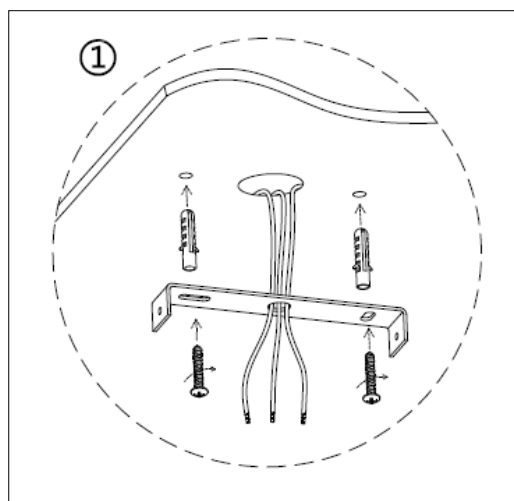

Step 2

Connect the input power cord into the right position of the connector which is inside of the ceiling rose.

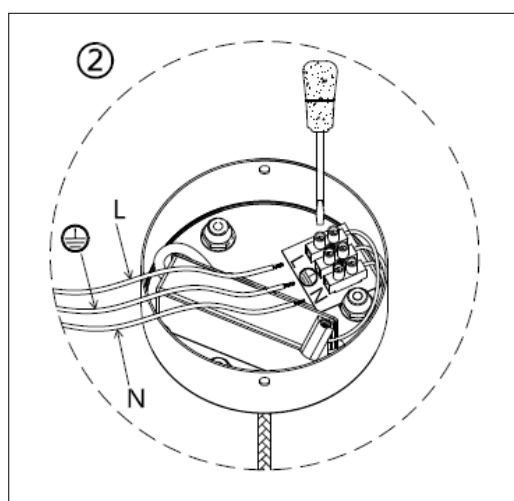

Step 3

Install the ceiling rose onto the fixed mounting bracket using two screws, one on each side.

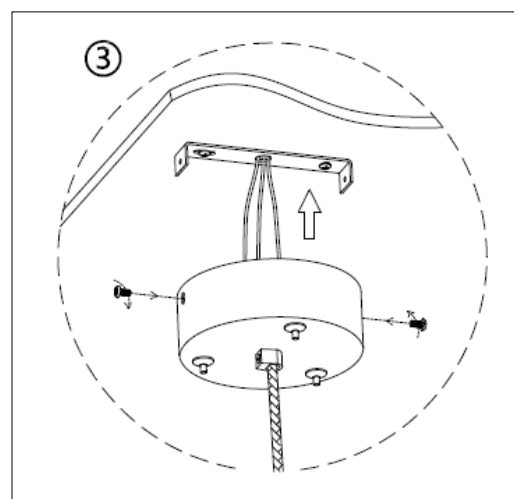

Step 4

Press the expansion device and insert three pieces of wire into the three expansion devices. Press onto the expansion device to adjust the height of the wire, adjust each of the three wires up and down to ensure the pendant is hung straight.

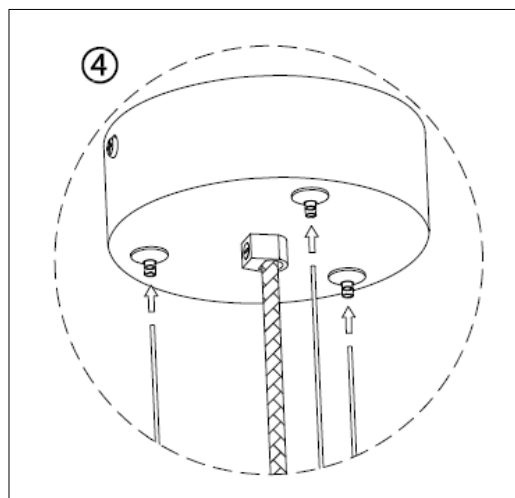

Step 5

Put the LED module kit into the glass shade, adjust the position of the three wings of LED module toward to the three gaps of the glass shade holder, place the LED module into the shade holder and then turn the LED module to lock them together.

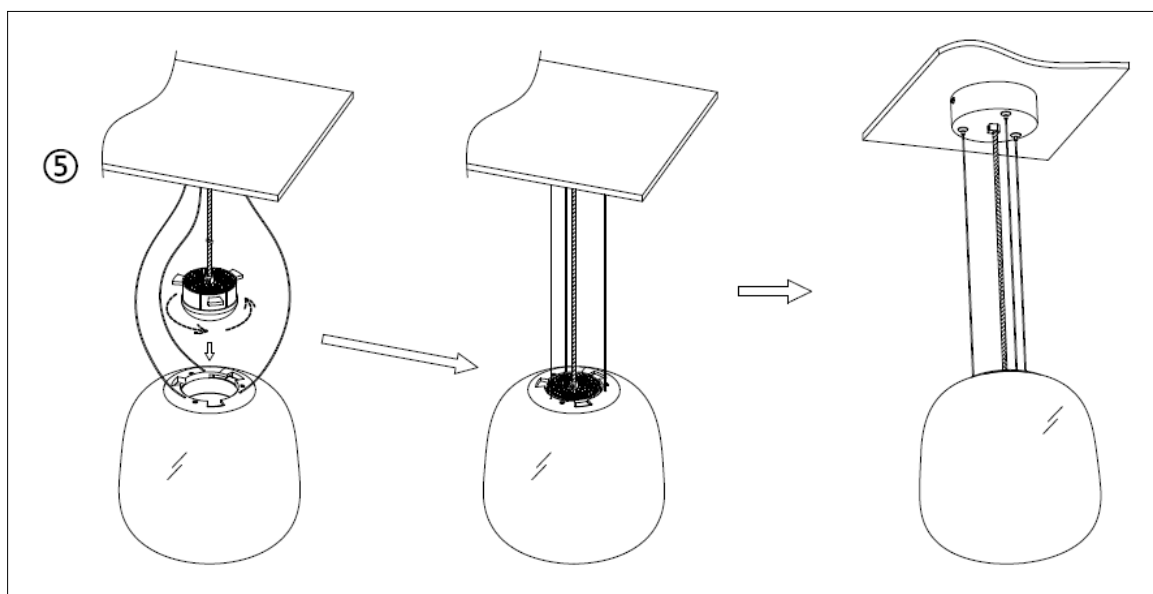

Installation & Assembly Instructions

Product Name	SKU	Cable Kit Specification				Glass Shade Specification	
		Input	Power	CCT.	Colour	Colour	Size
AB Pendant Light	EBL0001S	220-240VAC	12W	3000K	White	Clear	Φ257mm * H245mm
AB Pendant Light	EBL0002S	220-240VAC	12W	3000K	Black	Smoke Grey	Φ257mm * H245mm
AB Pendant Light	EBL0003S	220-240VAC	12W	3000K	White	Frosted Clear	Φ257mm * H245mm
AB Pendant Light	EBL0004S	220-240VAC	12W	3000K	Black	Frosted Smoke Grey	Φ257mm * H245mm
AB Pendant Light	EBL0001L	220-240VAC	12W	3000K	White	Clear	Φ322mm * H307mm
AB Pendant Light	EBL0002L	220-240VAC	12W	3000K	Black	Smoke Grey	Φ322mm * H307mm
AB Pendant Light	EBL0003L	220-240VAC	12W	3000K	White	Frosted Clear	Φ322mm * H307mm
AB Pendant Light	EBL0004L	220-240VAC	12W	3000K	Black	Frosted Smoke Grey	Φ322mm * H307mm



Made in China

IP20

Read the following instructions before handling the product:

1. Installation of this product must be carried out by a qualified electrician only.
2. Switch off the power of the mains supply and respectively of the connection lead before handling the product at installation, maintenance and cleaning etc.
3. Only to be operated with the specified driver.
4. Only for indoor use in dry conditions and not in dirt endangered rooms or in areas with high air humidity
5. The product must not be exposed to strong mechanical loads
6. Do not cover the product, as free air circulation must be provided
7. The product must not be modified and use only parts which are supplied with the product or are described as accessories
8. Operate the product only if it is working correctly.
9. Switch off the product with a malfunction immediately and operate it again only after examination by an electrical specialist in case of the following: Visible damage, it stop's working, smoke, steam or crackling sounds, overheating is observed.
10. Repairs or work on mains voltage may only be carried out by qualified electricians.
11. If the above instructions are not followed, short circuits and electrical shocks may occur.
12. If the external flexible cable or cord of this luminaire is damaged, it shall be exclusively replaced by the manufacturer or his service agent or similar qualified person in order to avoid a hazard.
13. The light source contained in this light shall only be replaced by the manufacturer or his service agent or similar qualified person.
14. Switch off the power of the mains supply as well as the connection lead before installing the product.
15. The LED bulbs have a warranty of 50,000 hours or 3 years, replacement bulbs and transformers are available but need to be fitted by a qualified electrician.
16. Please note: glass blowing is an organic hand made process, so there may be some imperfections like small air bubbles visible in the finished product, we do not classify this as a fault.