

CITTÀ

AB TABLE LAMP

PRODUCT MANUAL

Product Name	Model No.	Input	Power	CCT.	Color	
					Lamp Shade	Marble Base
AB Table	EBL0009	220-240VAC	1*2W	2700K	Frosted Clear	White
AB Table	EBL0010	220-240VAC	1*2W	2700K	Frosted Smoke Grey	Black

MADE IN CHINA

IP20







ATTENTION! Read the following instructions before handling the product:

- Switch off the power of the mains supply and respectively of the connection lead before handling the product at installation, maintenance and cleaning etc.!
- Only to be operated with the specified driver!
- Only for indoor use in dry conditions and not in dirt endangered rooms or in areas with high air humidity!
- The product must not be exposed to strong mechanical loads!
- Do not cover the product, as free air circulation must be provided!
- The product must not be modified and use only parts which are supplied with the product or are described as accessories!
- Operate the product only if it is working correctly.
- Switch off the product with a malfunction immediately and operate it again only after examination by an electrical specialist in case of the following: Visible damages appear; None work; Smoke, steam or crackling sounds appear; Overheating is observed.
- Repairs or work on mains voltage may only be carried out by qualified electricians.
- In case the above instructions are not followed, short circuits and let all electric shock may occur.
- If the external flexible cable or cord of this luminaire is damaged, it shall be exclusively replaced by the manufacturer or his service agent or similar qualified person in order to avoid a hazard.
- The light source contained in this light shall only be replaced by the manufacturer or his service agent or similar qualified person.
- Switch off the power of the mains supply and respectively of the connection lead before installing the product;
- Mount the carrying profile with countersunk screws;
- The LED bulbs have a warranty of 50,000 hours or 3 years, replacement bulbs, in line switches and wall plugs are available but need to be fitted by a qualified electrician.
- Please note: glass blowing is an organic hand made process, so there may be some imperfections like small air bubbles visible in the finished product, we do not classify this as a fault.

ASSEMBLY INSTRUCTIONS

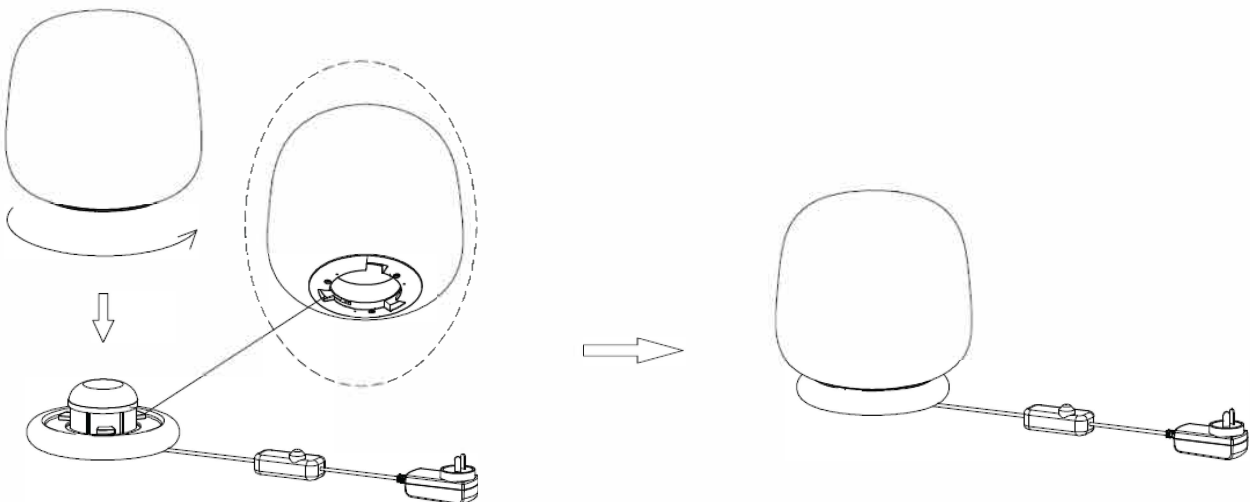

- ① Align the gaps at the bottom of the glass lampshade to the blades of the LED module.
- ② Put the glass lampshade onto the marble base.
- ③ Rotate the glass lampshade to clamp the blades into the gaps.