

CITTÀ

Pendant 45

Installation & Assembly Instructions

This product should only be installed by a registered electrician.
Please read product manual before installation.

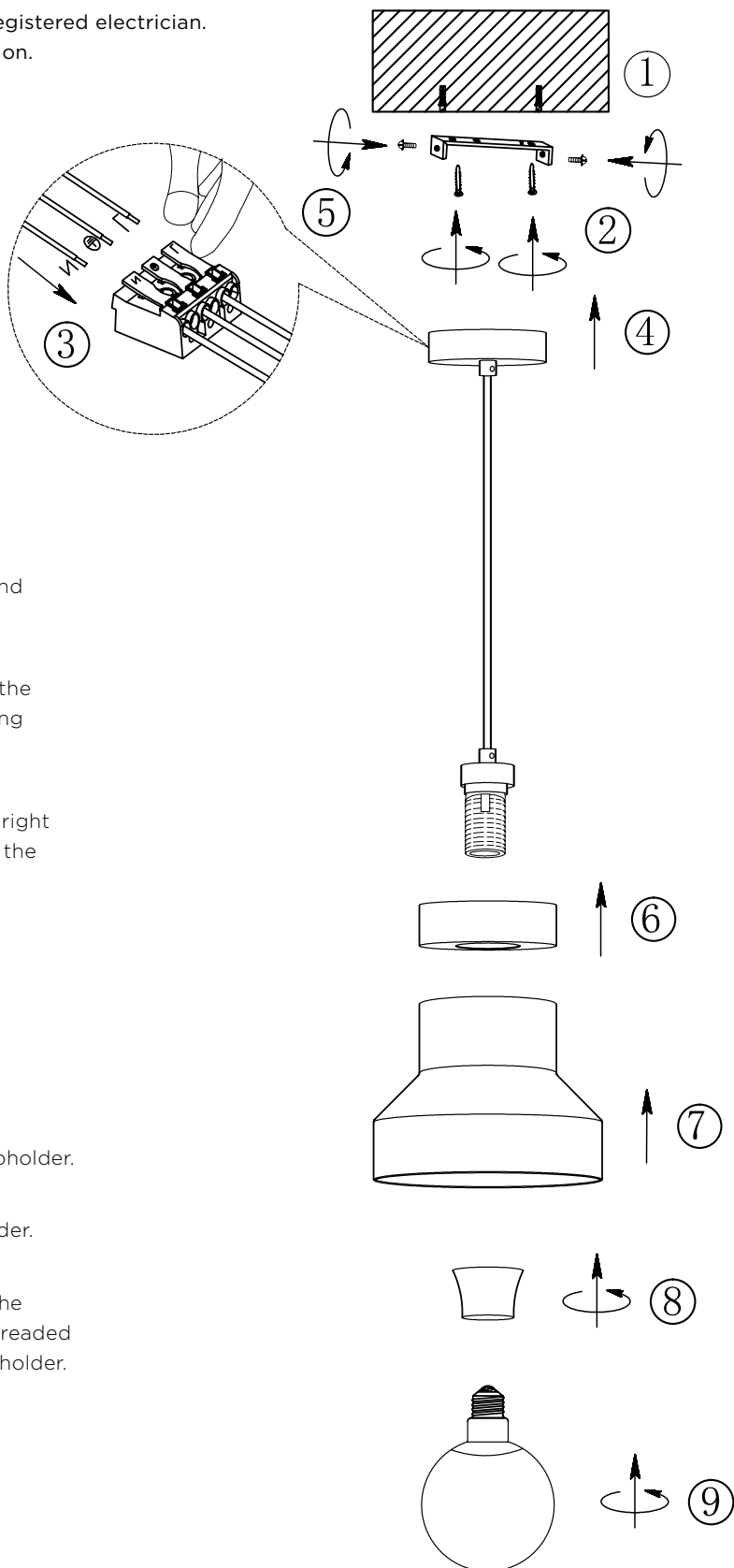

Steps

1. Locate the position for the ceiling rose and insert the plastic wall plugs if necessary.
2. Disassemble the mounting bracket from the ceiling rose, fix the bracket onto the ceiling with two screws.
3. Connect the input power cables into the right position of the connector which is inside the ceiling rose.
4. Locate the ceiling rose over the fixed mounting bracket.
5. Install the ceiling rose onto the fixed mounting bracket using the two screws.
6. Locate the top spun shade onto the lampholder.
7. Locate the main shade onto the lampholder.
8. Fix the top shade and main shade onto the lampholder by screwing on the plastic threaded component onto the bottom of the lampholder.
9. Screw in the Philips LED dolly bulb, which is supplied with the pendant.

Pendant 45 Ceiling Rose

This product should only be installed by a registered electrician. Please read product manual before installation.

If the external flexible cable or cord of this luminaire is damaged, it shall be exclusively replaced by the manufacturer or his service agent or a similar qualified person in order to avoid a hazard.

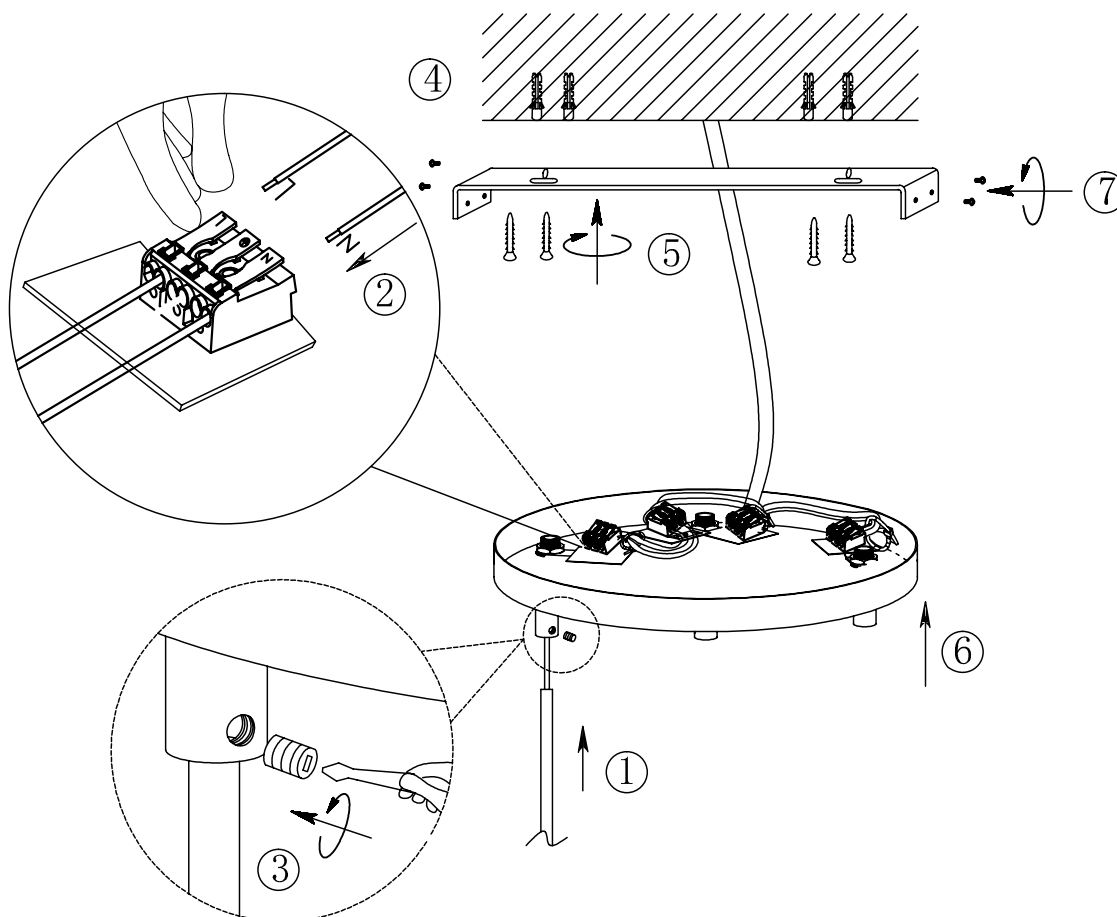

1. Loosen the grub screw on the side of the cord grip.
2. Connect the input power cables into the right position of the connector which is inside the ceiling rose.
3. Adjust each cable to the desired length and tighten the grub screw on the side of the cord grip. Repeat steps 1-3 for all three pendants.
4. Locate the position for the ceiling rose and insert the plastic wall plugs if necessary.
5. Disassemble the mounting bracket from the ceiling rose, fix the bracket onto the ceiling with the screws.
6. Locate the ceiling rose over the fixed mounting bracket.
7. Install the ceiling rose onto the fixed mounting bracket using the two screws.

Please note: This ceiling rose is a spare part, so the three small ceiling roses that come with the Pendant 45 aren't required to complete this light fitting. Please keep them on hand so if you ever decide to turn the Pendant 45's back into individual light fixtures you can re use them.

Pendant 45

Product Name	SKU	Colour	Input	Power	Size
Pendant 45	OLF0019	Black	220-240VAC	E27 1pc	ø195 × 150 mmh
Pendant 45	OLF0020	White	220-240VAC	E27 1pc	ø195 × 150 mmh



MADE IN CHINA

IP20

Read the following instructions before handling the product:

1. Installation of this product must be carried out by a qualified electrician only.
2. Switch off the power of the mains supply and the connection lead before handling the products installation, maintenance or cleaning.
3. Only to be operated with the supplied driver.
4. Only for indoor use in dry conditions and not in dirt endangered rooms or in areas with high air humidity.
5. The product must not be exposed to strong mechanical loads.
6. Do not cover the product, free air circulation must be provided.
7. The product must not be modified or converted. Only use parts which are supplied with the product or are described as accessories.
8. Only operate the product if it is working correctly.
9. If the product has a malfunction, switch it off immediately and operate it again only after examination by an electrical specialist in case of the following: Visible damage, the product does not work, smoke, steam or crackling sounds, overheating is observed.
10. Repairs or work on mains voltage may only be carried out by qualified electricians.
11. If the above instructions are not followed, short circuits and/ or electric shocks may occur.