

ANGLEPOISE®

Type 80™ | Designed by Sir Kenneth Grange

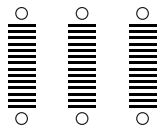
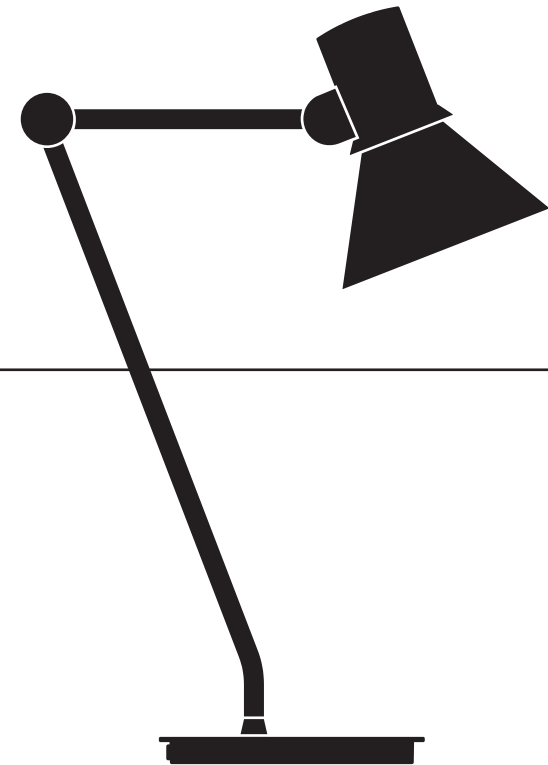

est. 1932

Type 80™
Table Lamp

Type 80™ Table Lamp

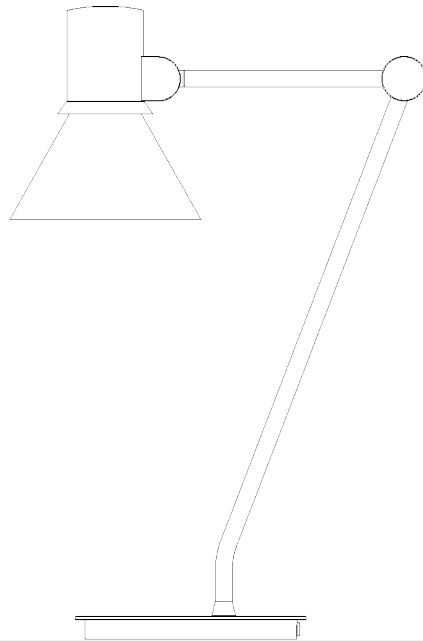

ASSEMBLY PARTS & TOOLS:

Your Anglepoise® comes supplied with everything you need to assemble and install your product. The assembly parts and tools you'll find in the box are:

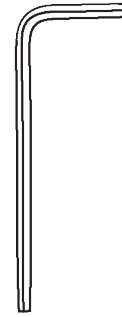

1 x 101928
Allen Key

PARTS NOT TO SCALE

ADJUSTMENT:

Your Anglepoise® lamp is a precision made product. The arm tension may be adjusted at the rear of the lamp to using the Allen Key provided to ensure perfect positioning of the top arm and shade for many years of use.

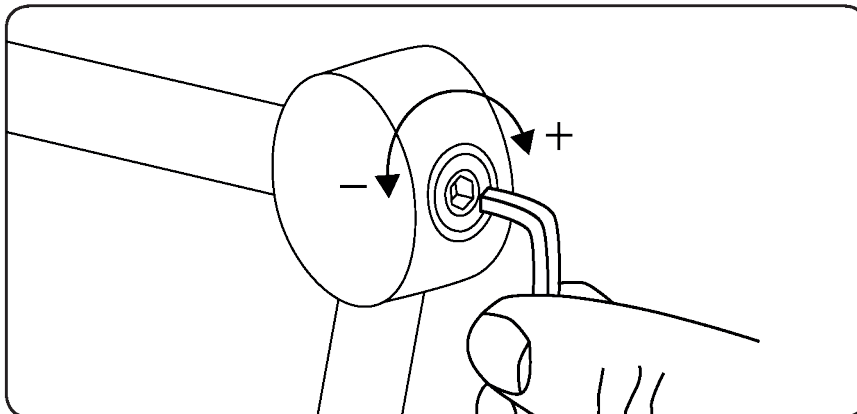

BULB INFORMATION:

We recommend using either an E27 LED bulb in your product with a colour temperature of 2700K. This colour temperature is suitable for most applications.

If you require a different light output you can use an alternative bulb.

Important: Do not use a bulb which exceeds the maximum wattage indicated inside the shade.

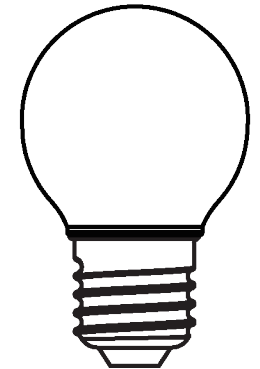

  0.2m   E27
220-240V AC ~50-60Hz  MAX 10W

INSTALLATION:

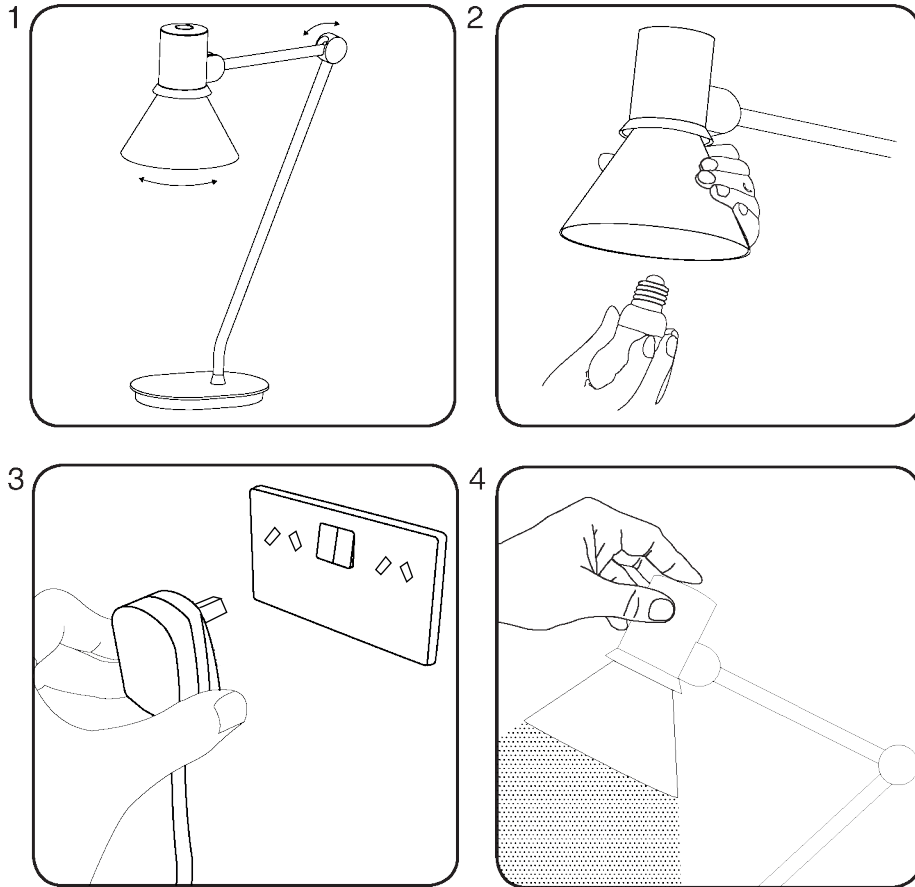

INSTRUCTIONS:

1. Place the product onto an even surface and adjust the product as required.
2. Screw in the bulb.
3. Plug the product in.
4. Turn lamp on using the switch at the top of the shade.

MAINTENANCE

Prior to cleaning or maintenance, always switch off and disconnect from the electricity supply and allow the shade to cool.

Clean with a soft, dry cloth avoiding using chemical based cleaners.

Repairs and the replacement of damaged cables or electrical parts should only be carried out by a qualified electrician, an authorised distributor or by Anglepoise® Ltd.

Your product should only be used in a dry indoor environment.

It is essential that any replacement bulb does not exceed the maximum wattage indicated inside the shade.

QUALITY AND SAFETY

This product is marked to demonstrate conformity with relevant directives.

The minimum operating distance from illuminated objects and surfaces is 0.2m
Rated Voltage: 220V-240V AC / 50-60Hz.